



CLIP & SHADE

**Motor for
external
roller blind**

Operating Instructions



Safety Instructions

General Information

- Warning notices in the instructions are marked with the following symbol.
- Read the instructions before using or operating the product.
- Follow all safety and adjustment instructions.



Access to the Remote Control (electrically operated product)

- The remote control is not suitable for children. Children may not recognize the potential dangers associated with the product.
- Improper use may result in personal injury.
- Do not allow children to play with the remote control.
- Keep the remote control out of reach of children.

Permitted Activities

- Only activities described in this manual are permitted. No other modifications, attachments, or alterations may be carried out without written approval from the manufacturer.

Description of Operation

- Press the button on the remote control. The product will move in the selected direction.
- The product can be stopped at any position using the stop button.
- In the upper and lower end positions, the drive will stop automatically once the end positions have been set.

Safety and Warning Notices

- All warnings in the instructions must be read and followed.
- The motor must be operated according to the operating instructions.
- There is a risk of falling during installation, removal, maintenance, or cleaning.

Operation & Maintenance

- During maintenance work or activities carried out in the immediate vicinity (e.g., window cleaning), the movement of the product must be prevented.
- Immediately after installation, check that the product is securely fixed in the window.
- In case of strong wind or longer periods of absence, the blind should be retracted.
- Regularly check the blind (at least every 3–6 months) to ensure it remains securely fixed in the window.



Scope of delivery



6-channel handheld transmitter



USB-C charger



+55 °C

-10 °C

Permissible temperature range for motor operation

ATTENTION: Only the charger supplied may be used for charging!



ATTENTION: The end positions are not yet programmed during delivery; this must be done carefully by the user on the installed roller blind!



Handheld transmitter

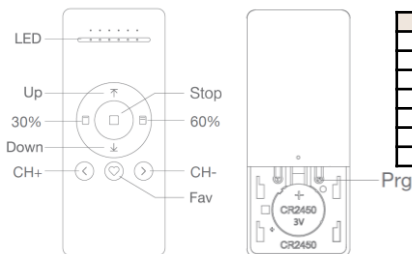

designation	explanation
LED	channel display
Stop	stop button
Up	up button
Down	down button
CH	channel adjustment
Fav	favourite position
Prg	programming button

Open the battery compartment on the back



1. Charging the motor

- Before use, charge the motor fully once (duration approx. 4-6 hours).
- Do not operate the motor while charging.
- It is recommended to charge the motor fully once before each colder season (autumn/winter).

2. Adjustment of upper and lower end positions

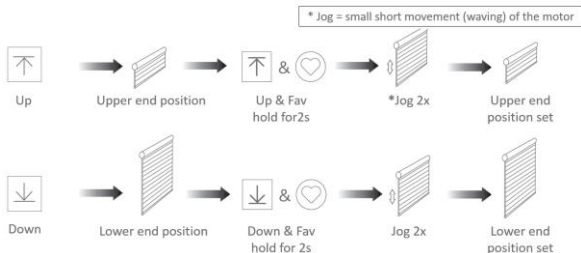

Before the end positions are set, the motor operates in jog mode. Press and hold the Up or Down button for 2 seconds, then the motor will run in continuous mode and can be stopped using the Stop button.

3. Set/delete favourite position

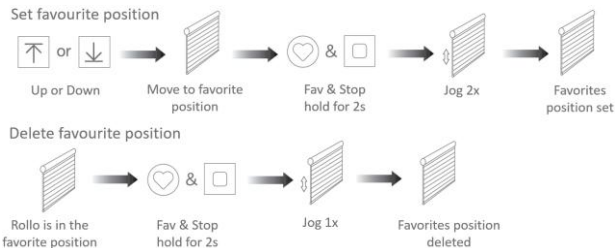



4. Optional: Readjust end positions

Adjust Upper limit



Adjust Lower limit

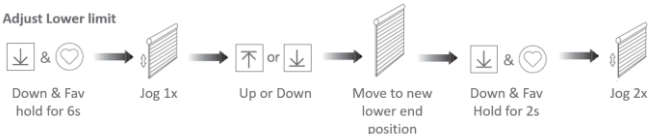

5. Optional: Delete end positions

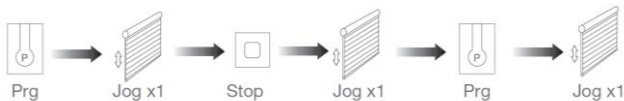

6. Optional: Change direction of rotation (end positions already set)





7. Hard-Reset – Only in the event of malfunctions or when restarting the engine

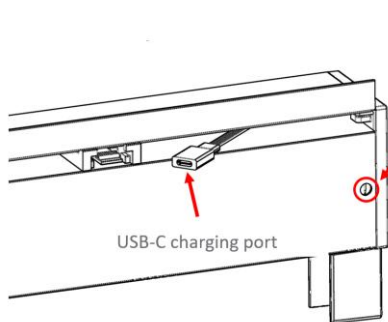

Use a thin object (e.g. paper clip) to press the reset button on the motor head for 16 seconds.

Jog x4 (once every 4s)

All settings are deleted if

- End position setting no longer works
- Handheld transmitter no longer responds

7.1 Restart the engine

Reset button on motor head

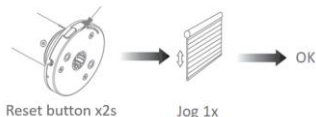

7.2 Connecting the motor to the handheld transmitter

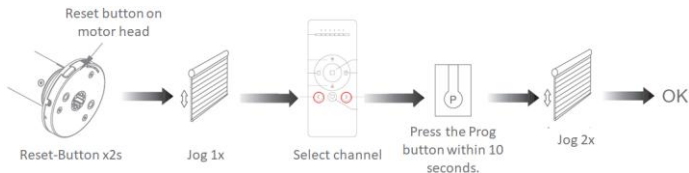



7.3 Change direction of rotation (end positions not yet set)

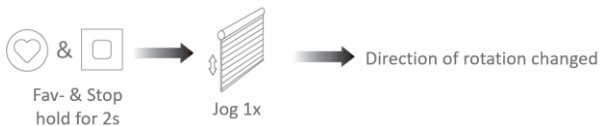

7.4 Adjustment of the upper and lower end positions (see point 2)

8. Service & Questions

Email: office@clipnshade.de



Disclaimer

CLIP'N'SHADE makes no representations or warranties regarding this manual and limits its liability for the breach of any implied warranty, to the extent permitted by law, to the replacement of this manual with another. Furthermore, CLIP'N'SHADE reserves the right to revise this publication at any time without obligation to notify any person of such revision.

The information provided in this documentation includes general descriptions and technical characteristics of the performance of the products described herein. This documentation cannot be used as a proper assessment of the suitability or reliability of the products for a specific user application and must not be used as a substitute for such an assessment. Neither CLIP'N'SHADE nor any of its partners can be held responsible or liable for misuse of the information contained herein. If you have any suggestions for improvements or additions, or if you have found errors in this publication, please notify us.

Failure to follow these instructions may result in injury or damage.

Copyright © 2023–2026 CLIP'N'SHADE

All rights reserved. No part of this publication may be reproduced, processed, or transmitted in any form, including photocopying, recording, or by any electronic or mechanical method, without the prior written permission of the manufacturer. Requests for permission must be submitted in writing to the publisher at the address below.

ClipnShade GmbH
Sedanstraße 21B
97082 Würzburg
E-Mail: info@clipnshade.de
Webseite: www.clipnshade.de

